

**SPECIFICATIONS**

Rated(额定参数): 300V,8A  
 Dielectric strength(抗电强度): AC1500V/1 Minute  
 Insulation Resistance(绝缘电阻):1000MΩ Min  
 Contact Resistance(接触电阻):20mΩ Max  
 Screw Torque(扭矩): 0.2Nm (1.7Lb.in)  
 Wire Range(线径):1.6~2.8AWG  
 Strip length(剥线长度):6~7mm  
 Temp. range(操作温度): -40℃~+105℃  
 MAX Soldering(瞬时温度):+250℃,5s

Housing Material(塑件): PA66 (UL94 V-0)  
 Contact(端子): Phosphor Bronze, Tin plating(磷铜镀锡)  
 Clamp(方块): Brass(黄铜), Ni plating(镀镍)  
 Screw (螺丝): M2.0 Steel, Zinc plating(钢,镀锌)

PITCH RANGE		NOMINAL DIMENSION RANGE					
IN MM	OVER	IN MM	OVER	IN MM	OVER	IN MM	OVER
6	10	10	30	60	100	150	OVER
T0	T0	T0	T0	T0	T0	T0	150
6	10	24	30	60	100	150	OVER
±0.10	±0.15	±0.25	±0.30	±0.30	±0.50	±0.70	±1.00

**Ordering Information**

JL15EDGKAM-XXX XX G X 1

Pitch  
 350=3.5PH  
 381=3.81PH  
 No.of pins  
 2P,3P,4P~24P  
 Housing Color  
 B=Black  
 G=Green  
 U=Blue  
 R=Red  
 W=White  
 Y=Yellow  
 O=Orange  
 F=Grey  
 Packing  
 0=Pe boog  
 T=Tube  
 A=Troy

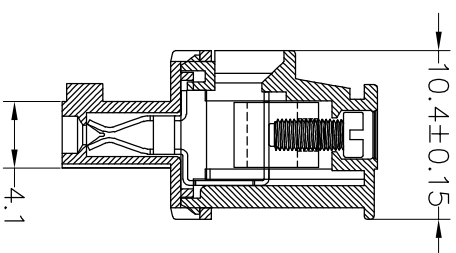
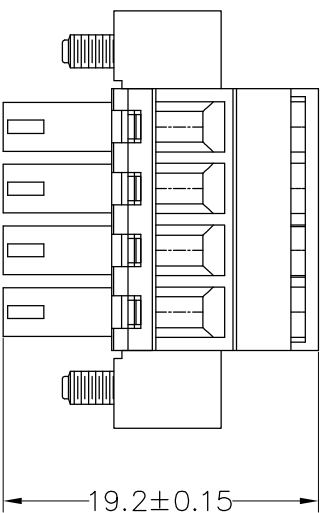
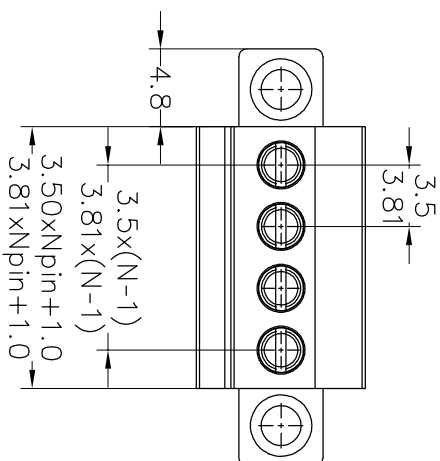

OPERATION	DRAW	BEN	17.01.05	SCALE	FIT	UNIT	SIZE	SHEET	PROJ.	PART NO.	TITLE:
XX						mm	A4	1/1		JL15EDGKAM-XXXXXXGX1	3.50/3.81 Pitch Female Pluggable Terminal Blocks
X.XX	CHECK										
X:XXX	±0.20										
Angle	±0.10										
DIM	±3°										
TOL											
APPROVE											
CHANGE											
MODIFICATION DESCRIPTION											
DATE	NEW DRAWING										
REV	2017.01.05										

**JINL** 深圳市锦凌电子有限公司  
 SHENZHEN JINLING ELECTRONIC CO.,LTD  
 Tel: 86-755-2997-5806/5802 Fax: 86-755-2997-5992